

# Hands Fitting Manual [9100]

## Appearance of Cal. 9100

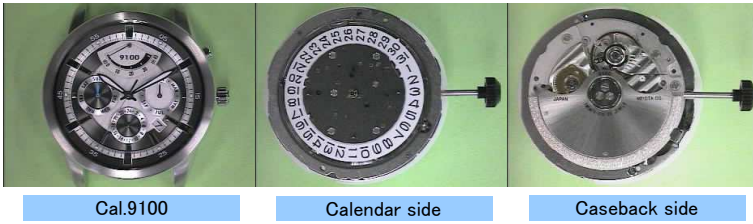

Cal.9100

Calendar side

Caseback side

### 1. Setting on the movement holder

Set Cal. 9100 as below pictures.

※Movement holder is enclosed with the products.

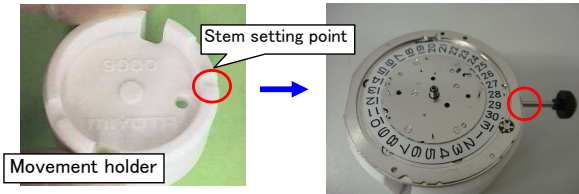

Stem setting point

Movement holder

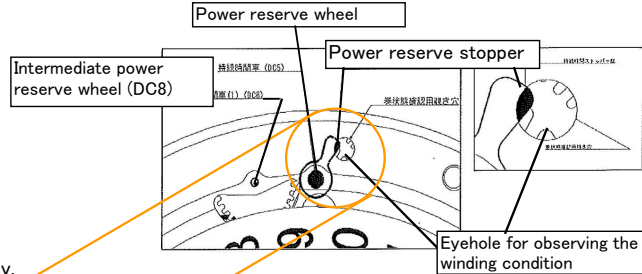

Power reserve wheel

Intermediate power reserve wheel (DC8)

Power reserve stopper

Eyehole for observing the winding condition

### 2. Winding fully the mainspring

Turn the crown clockwise in normal position and wind the mainspring fully.

※The mainspring becomes full-winded by turning the crown about 40times.

※The winding condition can be observed by checking the position of "Power reserve stopper" in eyehole.(See below pictures FYR).

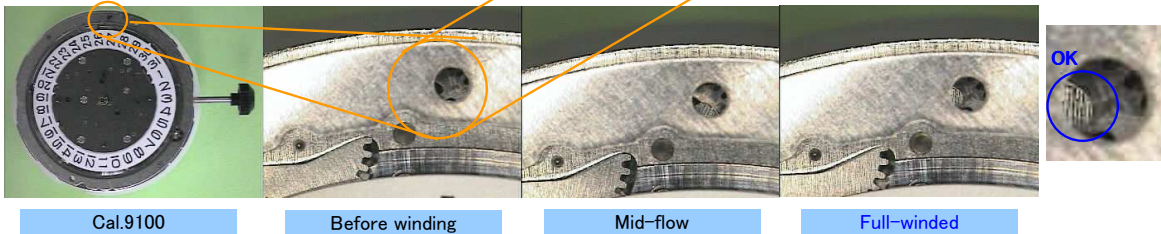

Cal.9100

Before winding

Mid-flow

Full-winded

OK

### 3. Setting the dial

a) Check if the dial legs are not bended before setting the dial.

b) Put the dial with the crown and dial 3H position as a guide.

c) Tighten the screws for dial fixing (screws are pre-assembled), and fix the dial.

\* Screws position are at 1H & 7H seeing from calendar side.

■In setting the dial make sure the dial is fixed if the dial side down.

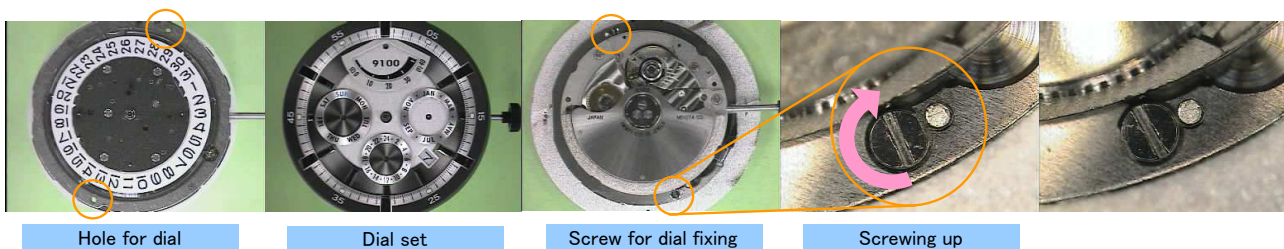

Hole for dial

Dial set

Screw for dial fixing

Screwing up

#### 4. Hands fitting

- a) Fitting power reserve hand
- b) Setting date ahead
- c) Fitting day hand
- d) Fitting month hand
- e) Fitting 24H hand
- f) Fitting hour, minute, sec hands
- g) Checking

- : Make sure the mainspring full-winded one more time, and fit the power reserve hand indicating "full" scale of the dial.
- : Turn the crown clockwise at 2nd position until the date changes to the next. And stop turning the crown on changing date calendar to the next date.
- ※Exceptionally avoid stopping date at 1st (31st → 1st).
- : Fit the day hand (Any day available).
- : Fit the month hand (Any month available).
- : Fit the 24H hand at 24H(0H) position.
- : Fit the hour, minute and second hands at 0H position.
- : Check following points.
  - ① Move hands and check each hands turning well & not touching each other.
  - ② Check if the date changes correctly by turning the crown clockwise at 1st position.
    - Check if the month hand moves when the date changes from 31st to 1st.
  - ※Avoid changing date from 20:30 to 2:00.
  - ③ Check if the day changes correctly by turning the crown counter-clockwise at 1st position.
  - ※Avoid changing day from 22:30 to 4:00.
  - ④ Check if the month changes correctly by pushing the button at 2H.
  - ※Avoid changing month from 22:30 in 31st to 0:00. in 1st
  - ⑤ Check if the date changes correctly after 24:00, and after that the day changes.



a) Power reserve hand

b) Date calendar

c) Day hand



d) Month hand

e) 24H hand

f) Hour, minute, sec

#### 5. Fitting case

- a) Clean inside the case by blowing the air.
  - ※Make sure not to blow the air around the balance wheel of movement.
- b) Pull out the interim stem as the following pictures show.
  - ※The stem can be pulled out easily by pushing the button near the stem.

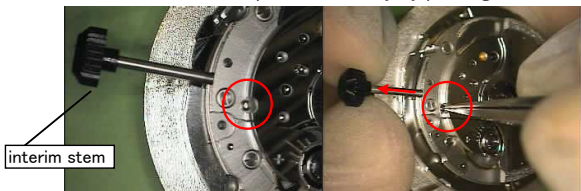

interim stem

Pull out stem with pushing button indicated by red coloured circle.

- c) Clean up the case & dial, and fit the movement into the case.



Case

Fitting the movement into the case (stem removed)

Caseback side

#### 6. Fitting movement holder

- a.) After matching stem position, and set the holder as following pictures.
  - \* Be careful not to push around the cock on this procedure.
- b.) After setting the holder, insert the stem slowly.
  - \* Check the crown is set and stem length is correctly adjusted.



Holder back

Holder Front

Setting the holder, insert the stem

stem

Use the dent to find correct position of movement holder.

Please use attached plastic movement holder on demand of your watch size when you assemble the watch. If attached plastic movement holder is not suitable, you can use your own movement holder.

#### 7. Fastening caseback

#### 8. Check the running condition

- a) Check the hands and case are not touching each other.
- b) Turn the crown and confirm the calendar and time adjusting can be done correctly.